

# A/C DETECTIVE WITH SNAP COUPLER INSTRUCTION SHEET

1. INSTALL BOTTLE OF DYE.
2. PURGE INJECTOR AND HOSE: INSERT ADAPTER (ITEM 8) INTO COUPLER BY PUSHING IN UNTIL LOCK/RELEASE SLEEVE SNAPS FORWARD.
3. SQUEEZE TRIGGER SLOWLY (REPEATEDLY) UNTIL DYE APPEARS AT COUPLER. CAUTION: DO NOT SQUEEZE TRIGGER UNLESS BOTTLE IS IN UPRIGHT POSITION.

**CAUTION!!!: DYE WILL SQUIRT FROM COUPLER IF TRIGGER IS SQUEEZED TOO FAST. IF DYE GETS ON PAINT OF CAR, IT CANNOT BE REMOVE.**

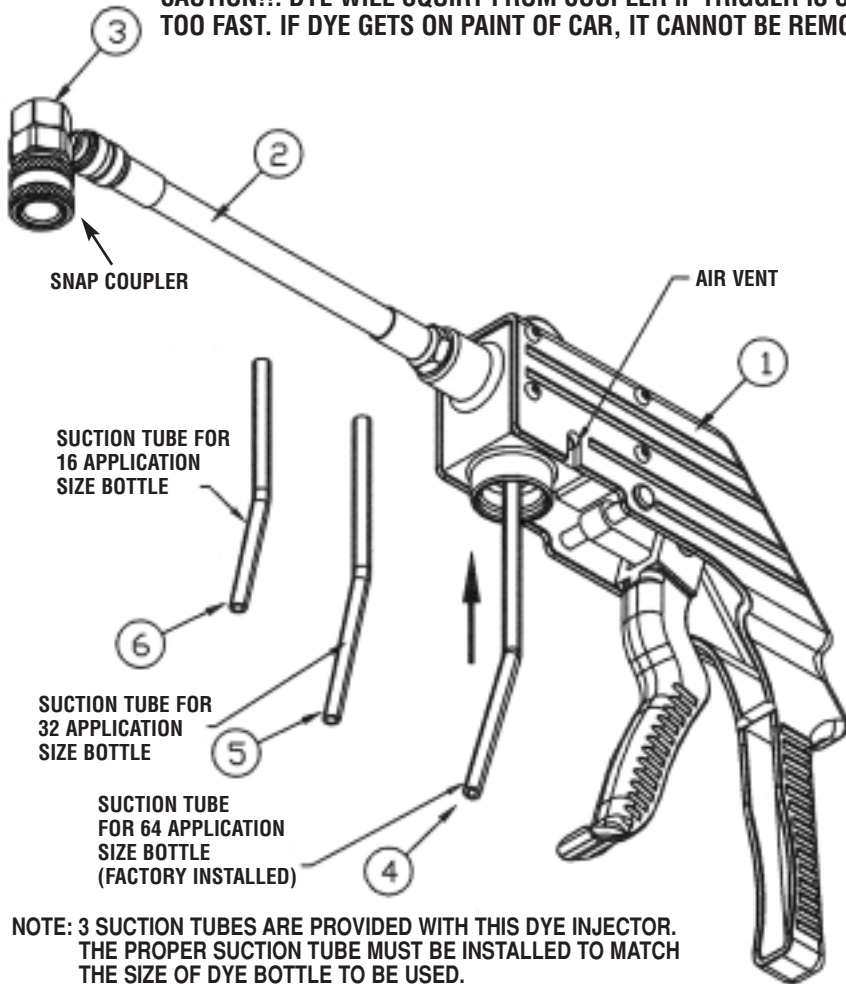

**NOTE: 3 SUCTION TUBES ARE PROVIDED WITH THIS DYE INJECTOR. THE PROPER SUCTION TUBE MUST BE INSTALLED TO MATCH THE SIZE OF DYE BOTTLE TO BE USED.**

#### TO REMOVE SUCTION TUBE:

1. GRASP SUCTION TUBE FIRMLY AND PULL STRAIGHT OUT OF BOTTLE PORT.  
NOTE: USE CLOTH OR SHOP RAG TO PROTECT HAND IF TUBE IS WET..

#### TO INSTALL SUCTION TUBE :

1. SELECT PROPER LENGTH SUCTION TUBE FOR SIZE OF DYE BOTTLE TO BE USED (SEE CHART IN PARTS LIST).
2. INSERT THE TUBE IN THE CENTER OF BOTTLE PORT AND PUSH IN FIRMLY UNTIL IT BOTTOMS IN COUNTER BORE..
3. MAKE SURE THE SUCTION TUBE POINTS AWAY FROM TRIGGER AS SHOWN.

4. REMOVE PURGE ADAPTER BY PULLING BACK ON LOCK/RELEASE SLEEVE. INJECTOR IS NOW PRIMED, READY FOR USE.
5. TO USE: ATTACH COUPLER TO SYSTEM, SQUEEZE TRIGGER ONCE TO INJECT 1/8 OZ. DYE (3,7 GRAMS). CAUTION: DO NOT SQUEEZE TRIGGER UNLESS BOTTLE IS IN UPRIGHT POSITON.
6. TO DISCONNECT: REMOVE COUPLER FROM SYSTEM BY PULLING BACK FIRMLY ON LOCK/RELEASE SLEEVE.
7. NOTE: IF INJECTOR STOPS PUMPING, PUSH IN AIR VENT TO RELEASE SUCTION IN BOTTLE.

**CAUTION:DO NOT SQUEEZE TRIGGER UNLESS BOTTLE IS IN UPRIGHT POSITION AS SHOWN.**

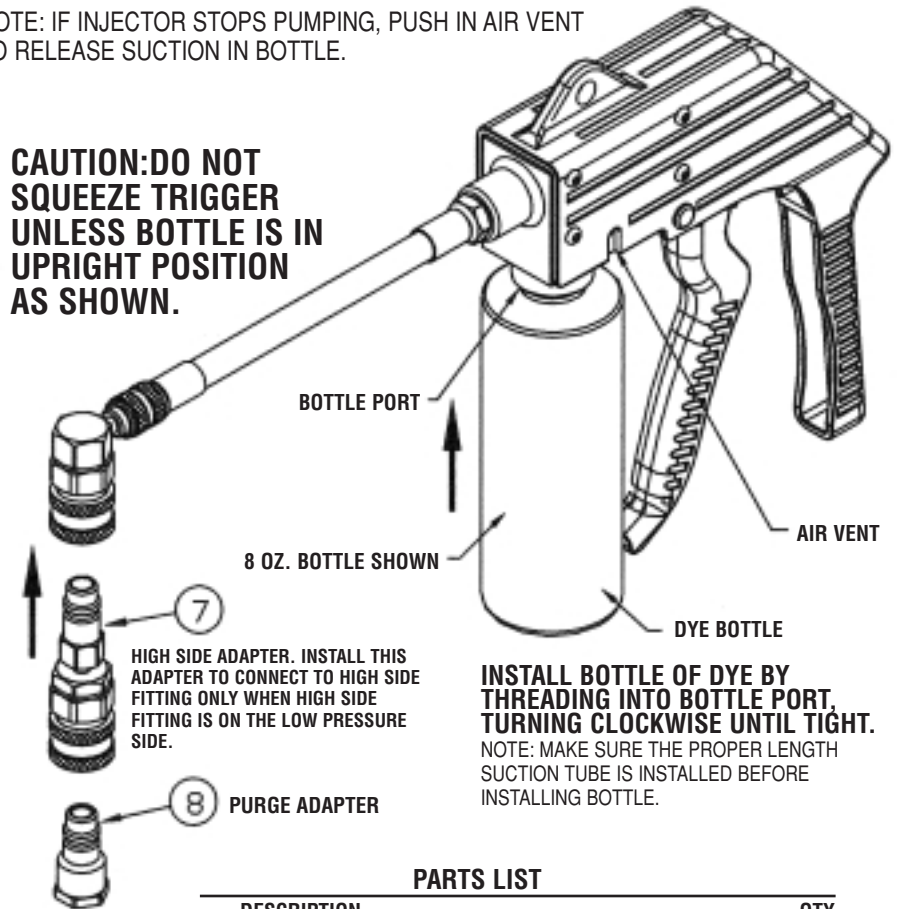

#### PARTS LIST

DESCRIPTION	QTY
1 A/C DETECTIVE DYE INJECTOR	1
2 HOSE ASSEMBLY	1
3 R134a LOW SIDE SNAP SERVICE COUPLER	1
4 SUCTION TUBE FOR 8 OZ. DYE BOTTLE (64 APPLICATIONS)	1
5 SUCTION TUBE FOR 4 OZ. DYE BOTTLE (32 APPLICATIONS)	1
6 SUCTION TUBE FOR 2 OZ. DYE BOTTLE (16 APPLICATIONS)	1
7 HIGH SIDE ADAPTER FOR LOW PRESSURE SIDE	1
8 PURGE ADAPTER	1